

ORDINANCE NO. 2465

AN ORDINANCE amending King County Zoning Resolution No. 25789, as amended, by amending the Zoning Map thereof reclassifying certain property thereon at the request of Washington Services, Inc., Division of Land Use Management File No. 128-73-P Div #1.

BE IT ORDAINED BY THE COUNCIL OF KING COUNTY:

SECTION 1. Washington Services, Inc. petitioned on October 9, 1973, that the property described in Section 3 below be reclassified from RS-15,000 to RS-9600 and this application was assigned Division of Land Use Management File No. 128-73-P.

SECTION 2. The report and recommendation of the Division of Land Use Management was transmitted to the Zoning and Subdivision Examiner On November 27, 1973, and hearing was held by the Examiner on the matter December 4, 1973. The report of the Examiner was filed with the Clerk of the King County Council on December 19, 1973, and the Council approved the reclassification by Motion No. 1378 on December 31, 1973, subject to conditions which have now been satisfied.

SECTION 3. The legal description of the property to be reclassified is attached as Appendix A and is hereby made a part of this ordinance. The above described property is shown on the attached map which is designated Appendix B and is hereby made a part of this ordinance.

SECTION 4. The King County Council does hereby amend King County Zoning Code, Resolution No. 25789, as amended, by reclassifying

1 that property described and shown in Section 3, Appendices A and B above,
2 to RS-9600 directs that Area Map E36-26-5 be modified to so designate.

3 INTRODUCED AND READ for the first time this 5th day
4 of November, 1973.

5 PASSED at a regular meeting of the King County Council
6 this 11th day of August, 1975.

7 KING COUNTY COUNCIL
8 KING COUNTY, WASHINGTON

9 Bill Pearson
10 Chairman

11
12
13 ATTEST:

14 Joan M. Owens
15 Clerk of the Council

DEEMED ENACTED WITHOUT
COUNTY EXECUTIVE'S SIGNATURE

16 APPROVED this _____ day of DATED: August 21, 1975.

17
18 _____
19 KING COUNTY EXECUTIVE
20
21
22
23
24
25
26
27
28
29
30
31

APPLICANT: Washington Services, Inc.

APPENDIX B

REQUEST: RS-15,000 to RS-9,600

STR: 36-26-4

2465

 Proposed
Reclassification

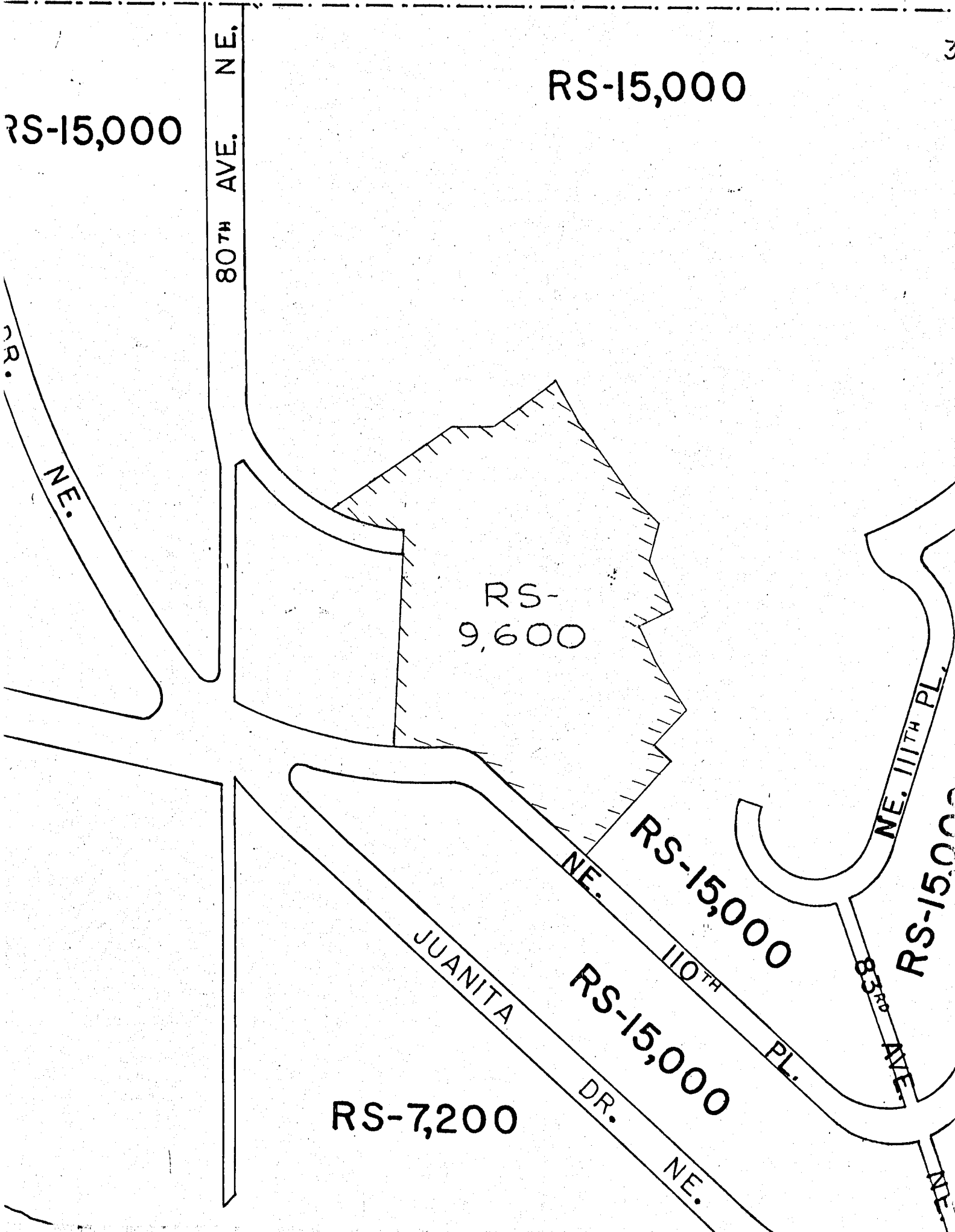

OVERALL LEGAL DESCRIPTION:

That portion of the Plat of Vista Hermosa, as recorded in Volume 31 of Plats, Page 20, records of King County, Washington; and that portion of the Plat of Juanita Point, a Residence Park, as recorded in Volume 25 of Plats, Page 27, Records of King County, Washington, described as follows:

Beginning at the most Southerly corner of Lot 112 of said Plat of Juanita Point; thence Northerly along the Southwesterly line of Lot 112 on a bearing of N 47°07'00" W for a distance of 123.28 feet; thence continuing N 47°06'00" W for a distance of 71.15 feet; thence on a curve to the left with a radius of 71.10 feet for a distance of 58.10 feet to the Southeast corner of Lot 120 of said Plat; thence Westerly along the South line of Lot 120 to the Westerly line of the East half of Lot 120; thence Northerly along said Westerly line and its Northerly extension to the South line of Lot 1 of said Plat of Vista Hermosa; thence Westerly along the South lines of Lots 1 and 2 of said plat to the most Westerly corner of Lot 2; thence Northeasterly along the Northwesterly line of Lot 2 to the most Northerly corner of Lot 2; thence Easterly in a straight line to the most Westerly corner of Lot 55 of said Plat; thence Northeasterly along the Northwesterly line of said Lot 55 a distance of 127.06 feet; thence S 19°15'53" E 7.26 feet thence S 27°13'42" E 76.34 feet; thence S 34°51'20" E 160.08 feet; thence S 45°13'25" E 10.17 feet; thence S 43°45'11" E 47.70 feet; thence S 15°44'52" W 68.35 feet; thence S 25°00'00" E 92.00 feet; thence S 65°00'00" W 67.00 feet; thence S 25°00'00" E 50.00 feet; thence S 31°35'18" E 121.97 feet; thence S 42°54'00" W 75.00 feet; thence S 47°06'00" E 33.87 feet to a point on the Northeasterly line of Lot 111 in said plat of Juanita Point a Residence Park; said point lying 60.00 feet distant from the most Northerly corner of said Lot 111; thence S 42°54'00" W, parallel with the Northwesterly line of said Lot 111, a distance of 220.00 feet to the Northerly margin of N.E. 110th Street (MONTE VISTA ROAD); thence N 47°06'00" W along said margin, 60.00 feet to the most Southerly corner of Lot 112 and the Point of Beginning.